

INSTALLATION AND SERVICE MANUAL

For Installation of KWH 1, 2 Wall Light LED Model. UKWH-30001 and UKWH-30011

PRODUCT DRAWING (DIMENSIONS)

SUITABLE FOR WET LOCATIONS

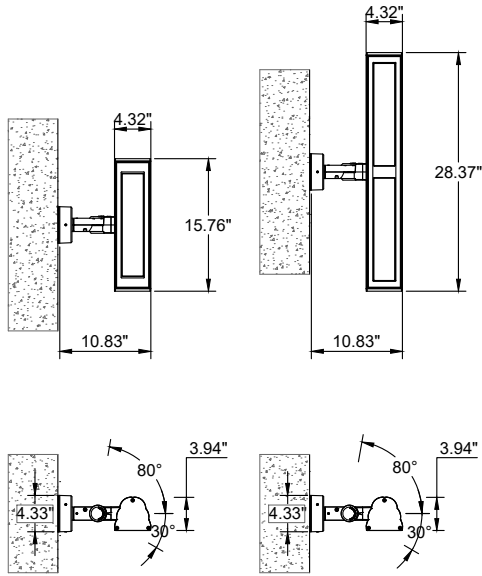

UKWH-30001

UKWH-30011

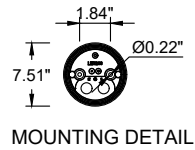

MOUNTING DETAIL

NOTE

Mounts over Junction box. ①

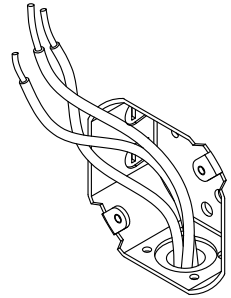

②

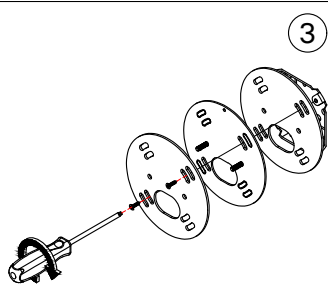
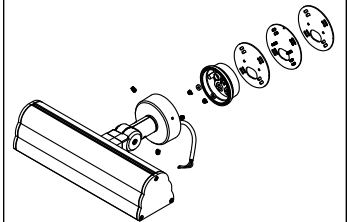

③

white nylon washers must be used to prevent water intrusion

④

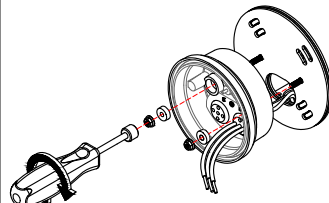

"Orange grommet must be installed to seal the cable entry."

⑤

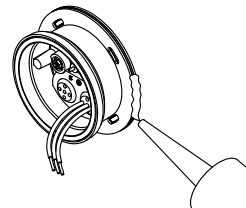

Ensure watertight seal using UL approved silicone based sealant.

Connect Power and Ground Wire.

⑥

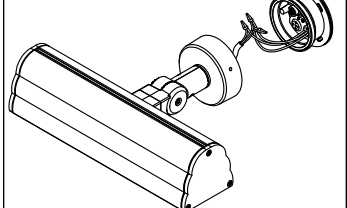

⑦

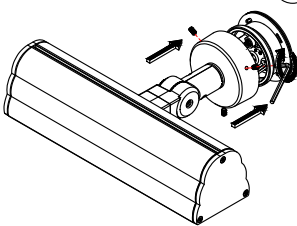

⑧

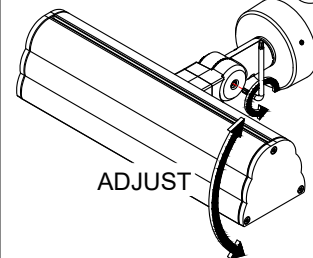

ADJUST

⑨

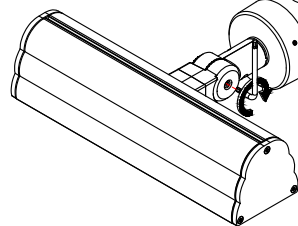

⑩

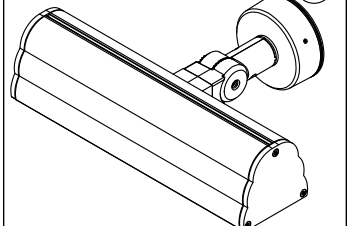

Notice to installer :

WIRING INSTRUCTIONS Warning : RISK OF FIRE AND ELECTRICAL SHOCK. : FIXTURE MUST BE INSTALLED BY A QUALIFIED ELECTRICIAN ONLY>FIXTURE IS INTENDED FOR INSTALLATION IN ACCORDANCE WITH THE NATIONAL ELECTRICAL CODE, LOCAL AND FEDERAL CODE SPECIFICATIONS. DISCONNECT POWER BEFORE SERVICING.

Ligman Lighting USA

7144 NE Progress Court, Hillsboro
Oregon, 97124, USA
Tel : 503 645 0500 | Fax : 503 645 8100